

Rigging the Hire Fleet Topper

Assemble the Mast

1. Line up the two mast sections ensuring the tape on the upper mast section and the bottom mast section align.

The slots in the upper section need to engage with the rivets in the bottom section.



- ⇒ Ensure the upper mast has the larger side of the mast-head crane facing forward.
- ⇒ Ensure the metal loop/ring at the bottom of the bottom mast section is facing backwards.

Sleeving the sail

1. Work with your back to the wind.
2. Unfold the sail and lay it on the ground with the bottom of the sail luff sleeve near the top of the mast and insert the mast into the luff sleeve.

- ⇒ Ensure the sail is facing the same way as the metal loop/ring on the bottom mast section.



3. Push the mast into the sail sleeve until the whole sail is sleeved and mast-head has appeared at the top.
4. Use the halyard loop attached to the mast crane to secure the top of the sail to the mast. – see diagram below.

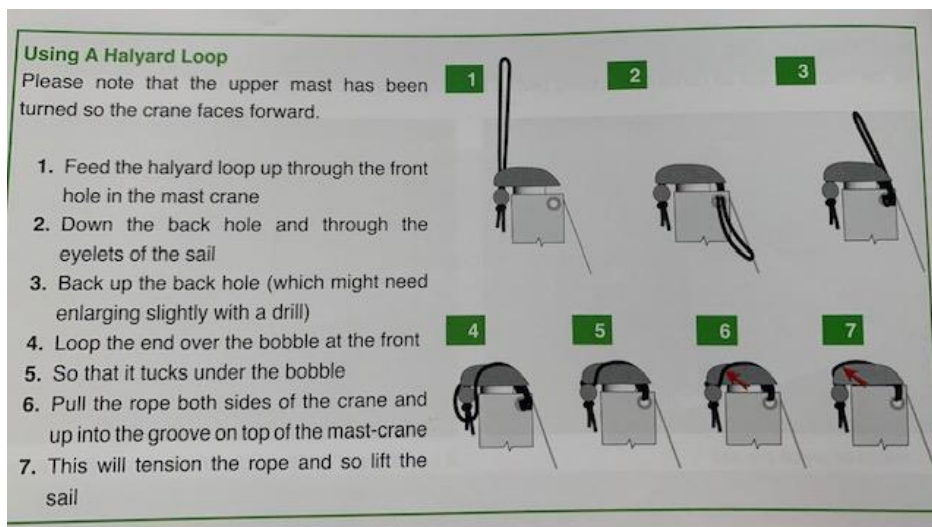

Insert the mast.

1. Point the boat into the wind and ensure the mast gate is open.
2. Lift the mast and insert at a 45 degree angle engaging the base of the mast into the mast cup under the mast gate.
3. Walk the mast forward and into an upright position ensuring the mast collar is underneath the mast gate.
4. Pull the cord on the starboard side to close the gate.
5. Push the starboard toggle in firmly to lock the gate.
6. Tie a safety knot in the excess cord to prevent the mast gate unlocking.

Fit the boom.

1. Push the gooseneck on to the mast above the mast collar.

Sail controls.

All the sail controls are already rigged on the boom and the mast.

Outhaul.

1. Take the clew hook and attach it to the clew cringle of the sail.
2. From the back of the boom, take the karabiner on the outhaul line and attach it to the clew cringle of the sail.
3. Tension the outhaul line as required through the locking cleat on the underside of the boom forward of the mainsheet metal hoop/ring.

Downhaul. (Cunningham).

1. Clip the downhaul hook through both tack cringles on the sail/loop on the sail, ensuring the line passes the boom to its starboard side.

Kicker. (Vang).

1. Clip the hook of the kicker on to the metal hoop/ring on the underside of the boom.

Mainsheet.

Already rigged.

Rudder.

1. With the rudder in the raised position, pass the tiller under the rope traveller (horse) and lower the rudder onto the transom fitting.

- ⇒ Ensure that it is completely home and that the spring retaining clip has engaged to prevent the rudder becoming detached in the event of a capsize.
- 2. Pass the safety line under the traveller and attach to one of the diagonal lines going forward across the rear deck.

Almost done.

Check the **self-bailer is closed** and the **bung in the transom is in and secure**.

Daggerboard.

1. Insert the daggerboard after launching when preparing to set off.
2. Using the clip on the daggerboard shock cord attach to the loop on the short end of the painter attached to the bow.

Finally

Adjust sail controls to suit weather conditions and your ability and off you go.

Reefing.

1. Start with the sail rigged normally.
2. Take the kicker off at the mast end only.
3. Tighten the downhaul.
4. Ease out the outhaul.
5. Rotate the mast clockwise twice.
 - ⇒ If needed release the outhaul clip attached to the mainsail loop/ring to extend the outhaul.
6. Adjust the outhaul.
7. Re attach the kicker to the bottom of the mast.